



**31 Greensey, Ragged Appleshaw, Andover, SP11 9HY**  
**Guide Price £450,000**





## 31 Greensey, Ragged Appleshaw Andover, Guide Price £450,000

### PROPERTY DESCRIPTION BY Mr Ross Beeden

Graham & Co are delighted to offer to the market this beautifully presented three bedroom semi detached family home. This well loved family home has been extended to the rear and now spans over 1100 square feet. The accommodation comprises a hallway, cloakroom, sitting room with a stunning log burner, dining room/family area and a modern fitted kitchen. upstairs is home to three double bedrooms and a family bathroom. Outside there is a rear garden with canvass views over the countryside. To the front there is a driveway for multiple cars.







The picturesque village of Appleshaw is just five minutes from both Andover and Tidworth and only a couple of miles from the A303. This small parish lies on the Wiltshire/Hampshire border and includes the hamlets of Redenham and Ragged Appleshaw. The village itself boasts a thriving community, St Peter's Church of England primary school, village hall, recreation ground, The Walnut Tree Inn and church. The nearest train station can be found in Andover with services to London Waterloo in just over an hour.







**APPROXIMATE GROSS INTERNAL AREA = 1145 SQ FT / 106.4 SQ M**  
**SHEDS = 59 SQ FT / 5.5 SQ M**  
**TOTAL = 1204 SQ FT / 111.9 SQ M**



= Reduced headroom below 1.5m / 5'0"

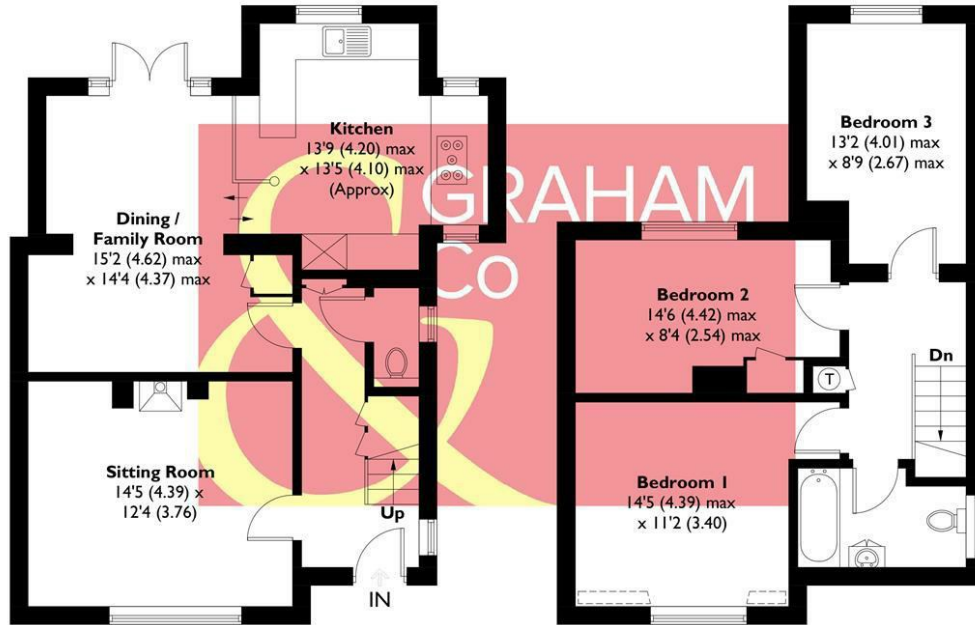

**GROUND FLOOR**  
**636 SQ FT / 59.1 SQ M**

**FIRST FLOOR**  
**509 SQ FT / 47.3 SQ M**

**Shed**  
 5'11 (1.80) x  
 3'10 (1.17)  
 (Not Shown In Actual  
 Location / Orientation)

**Shed**  
 7'2 (2.18) x  
 5'2 (1.57)  
 (Not Shown In Actual  
 Location / Orientation)

This plan is for layout guidance only. Not drawn to scale unless stated. Windows and door openings are approximate. Whilst every care is taken in the preparation of this plan, please check all dimensions, shapes and compass bearings before making any decisions reliant upon them. Created by Emzo Marketing (ID1270264)  
**Produced for Graham & Co**

## MORTGAGE ADVICE Across The Market Mortgages

An independent Mortgage brokerage offering expert advice from across the whole market. Whether you are a first-time buyer, home mover, remortgaging or buying a Buy-To-Let investment. Tristan can provide expert & reliable advice, in a clear jargon free language. Book a free consultation today.

E - [tristan@atmmortgages.com](mailto:tristan@atmmortgages.com) M - 07545320380

[www.atmmortgages.com](http://www.atmmortgages.com)

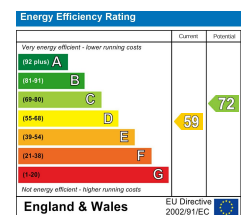

**Tax Band: C**



**OPEN 7 DAYS**

If you are considering selling your home  
 please contact us today for your free  
 no obligation valuation

**01264 356500**

IMPORTANT: we would like to inform prospective purchasers that these sales particulars have been prepared as a general guide only. A detailed survey has not been carried out, nor the services, appliances and fittings tested. Room sizes should not be relied upon for furnishing purposes and are approximate. If floor plans are included, they are for guidance only and illustration purposes only and may not be to scale. If there are any important matters likely to affect your decision to buy, please contact us before viewing the property.

